

# SUN ODYSSEY 380

Ocean Breeze (2022)



Silver Sail Ltd • Kralja Zvonimira 14 • 21000 Split • Croatia

Phone: +385 99 2608 224

E-mail: info@silversail.hr

Web: www.silversail.hr

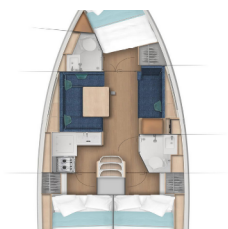

|                        |  |
|------------------------|--|
| <b>Yacht Base</b>      | Fethiye, Ece Saray Marina Resort, Turkey |
| <b>Yacht ID</b>        | 8685                                     |
| <b>Yacht Brands</b>    | Jeanneau                                 |
| <b>Yacht Name</b>      | Ocean Breeze                             |
| <b>Production Year</b> | 2022                                     |
| <b>Length</b>          | 37 Ft                                    |
| <b>Cabins</b>          | 3  |
| <b>Berths</b>          | 6 + 1                                    |
| <b>Persons</b>         | 7  |
| <b>WC/Shower</b>       | 2  |

**DECK:** Anchor chain counter, Bathing platform, Bimini top, Bosun's chair (Safe seat)(boatswain's chair), Cockpit light, Cockpit table, Cockpit/stern, outside shower, Dinghy, Electric anchor windlass, Fenders, Gangway, Sprayhood

**ENTERTAINMENT:** Fusion radio, Mask and snorkel, Outdoor speakers, Radio, USB, Bluetooth, Underwater lights

**GALLEY:** Hot water, Kitchen utensils (Galley equipment, cutlery), Oven, Refrigerator

**INTERIOR:** Electric fans in cabins, Electric toilet

**NAVIGATION:** Autopilot, GPS chart plotter, Navigation (Nautical) charts and nautical guide , Radar reflector, Wind/speed/depth instruments

**SAFETY:** Distress signals, Emergency tiller, Fire extinguisher , First aid kit , Fog horn, Life belts (Safety harness), Life buoy + Flashing light, Life jacket (children), Liferaft , VHF radio

**YACHT ELECTRICS:** Bilge pump - Electric, DSC station, Heating, Inverter, Solar panels

## PRICE AND AVAILABILITY

Sun Odyssey 380 Ocean Breeze (2022)



|   |   |                                       |   |
|---|---|---------------------------------------|---|
| <b>19.10. - 26.10.2024</b><br>Not available | <b>26.10. - 02.11.2024</b><br>Not available | <b>02.11. - 09.11.2024</b><br>1.812 € | <b>09.11. - 16.11.2024</b><br>Not available |
| <b>16.11. - 23.11.2024</b><br>1.566 €       | <b>23.11. - 30.11.2024</b><br>1.240 €       | <b>30.11. - 07.12.2024</b><br>1.240 € | <b>07.12. - 14.12.2024</b><br>1.240 €       |
| <b>14.12. - 21.12.2024</b><br>1.240 €       | <b>21.12. - 28.12.2024</b><br>1.240 €       | <b>04.01. - 11.01.2025</b><br>1.771 € | <b>11.01. - 18.01.2025</b><br>1.771 €       |
| <b>18.01. - 25.01.2025</b><br>1.771 €       | <b>25.01. - 01.02.2025</b><br>1.708 €       | <b>01.02. - 08.02.2025</b><br>1.708 € | <b>08.02. - 15.02.2025</b><br>1.708 €       |
| <b>15.02. - 22.02.2025</b><br>1.708 €       | <b>22.02. - 01.03.2025</b><br>1.708 €       | <b>01.03. - 08.03.2025</b><br>1.708 € | <b>08.03. - 15.03.2025</b><br>1.708 €       |
| <b>15.03. - 22.03.2025</b><br>1.708 €       | <b>22.03. - 29.03.2025</b><br>1.708 €       | <b>29.03. - 05.04.2025</b><br>1.708 € | <b>05.04. - 12.04.2025</b><br>2.113 €       |
| <b>12.04. - 19.04.2025</b><br>2.113 €       | <b>19.04. - 26.04.2025</b><br>2.113 €       | <b>26.04. - 03.05.2025</b><br>2.113 € | <b>03.05. - 10.05.2025</b><br>2.113 €       |
| <b>10.05. - 17.05.2025</b><br>2.113 €       | <b>17.05. - 24.05.2025</b><br>2.500 €       | <b>24.05. - 31.05.2025</b><br>2.518 € | <b>31.05. - 07.06.2025</b><br>2.923 €       |

## PRICE AND AVAILABILITY

Sun Odyssey 380 Ocean Breeze (2022)



|                                       |                                       |                                       |                                       |
|---------------------------------------|---------------------------------------|---------------------------------------|---------------------------------------|
| <b>07.06. - 14.06.2025</b><br>3.283 € | <b>14.06. - 21.06.2025</b><br>3.283 € | <b>21.06. - 28.06.2025</b><br>2.923 € | <b>28.06. - 05.07.2025</b><br>2.923 € |
| <b>05.07. - 12.07.2025</b><br>2.923 € | <b>12.07. - 19.07.2025</b><br>2.923 € | <b>19.07. - 26.07.2025</b><br>2.923 € | <b>26.07. - 02.08.2025</b><br>2.923 € |
| <b>02.08. - 09.08.2025</b><br>3.283 € | <b>09.08. - 16.08.2025</b><br>3.283 € | <b>16.08. - 23.08.2025</b><br>3.283 € | <b>23.08. - 30.08.2025</b><br>3.283 € |
| <b>30.08. - 06.09.2025</b><br>3.283 € | <b>06.09. - 13.09.2025</b><br>3.283 € | <b>13.09. - 20.09.2025</b><br>3.283 € | <b>20.09. - 27.09.2025</b><br>3.283 € |
| <b>27.09. - 04.10.2025</b><br>3.283 € | <b>04.10. - 11.10.2025</b><br>3.283 € | <b>11.10. - 18.10.2025</b><br>3.283 € | <b>18.10. - 25.10.2025</b><br>2.923 € |
| <b>25.10. - 01.11.2025</b><br>2.518 € | <b>01.11. - 08.11.2025</b><br>2.518 € | <b>08.11. - 15.11.2025</b><br>2.113 € | <b>15.11. - 22.11.2025</b><br>1.708 € |
| <b>22.11. - 29.11.2025</b><br>1.708 € | <b>29.11. - 06.12.2025</b><br>1.708 € | <b>06.12. - 13.12.2025</b><br>1.708 € | <b>13.12. - 20.12.2025</b><br>1.708 € |
| <b>20.12. - 27.12.2025</b><br>1.708 € |                                       |                                       |                                       |