

SUN ODYSSEY 380

4 Elli (2023)



Silver Sail Ltd • Kralja Zvonimira 14 • 21000 Split • Croatia

Phone: +385 99 2608 224

E-mail: info@silversail.hr

Web: www.silversail.hr

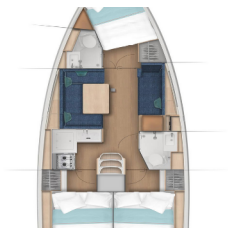

| | |
|------------------------|-----------------------------|
| Yacht Base | ACI Marina Skradin, Croatia |
| Yacht ID | 8138 |
| Yacht Brands | Jeanneau |
| Yacht Name | 4 Elli |
| Production Year | 2023 |
| Length | 37 Ft |
| Cabins | 3 |
| Berths | 6 + 2 |
| Persons | 8 |
| WC/Shower | 2 |

COMFORT: Cockpit cushions

DECK: Anchor, Bathing platform, Bimini top, Bosun's chair (Safe seat)(boatswain's chair), Cockpit table, Cockpit/stern, outside shower, Dinghy, Electric anchor windlass, Fenders, Gangway, Ropes, Sprayhood, Swimming ladder, Teak cockpit, Water hose

ENTERTAINMENT: Outdoor speakers, Radio mp3 player

GALLEY: Gas bottles, Hot water, Kitchen utensils (Galley equipment, cutlery), Refrigerator, Stove

INTERIOR: Barometer, Clock, Electric fans

NAVIGATION: AIS, Autopilot, Binoculars, Bow thruster, Cockpit control panel, Compass, Echosounder/Depthsounder, GPS chart plotter, Hand bearing compass, Harbour guides, LED Navigation lights, List of lights, Log, Nautical charts, Pilot book, Radar reflector, Speedometer (Speed log), Wind instrument/Anemometer, Windex

SAFETY: Automatic Inflatable Life Jacket, Black Water Tank, Distress flare box, Distress signals, Emergency tiller, EPIRB-Distress radio beacons, Fire extinguisher, First aid kit, Floating light, Fog horn, GMDSS - Global Maritime Distress and Safety System, Horseshoe lifebuoy, Inflatable life raft, Life belts (Safety harness), Life jackets, Set of tools

YACHT ELECTRICS: Battery charger, Bilge pump - Electric, Heating, Inverter, Plug 220V, 12 V, Solar panels

PRICE AND AVAILABILITY

Sun Odyssey 380 4 Elli (2023)



| | | | |
|--|--|--|--|
| 02.11. - 09.11.2024 1.551 € 2.068 € | 09.11. - 16.11.2024 1.551 € 2.068 € | 16.11. - 23.11.2024 1.551 € 2.068 € | 23.11. - 30.11.2024 1.551 € 2.068 € |
| 01.12. - 31.12.2024 Not available | 01.01. - 07.03.2025 Not available | 08.03. - 15.03.2025 800 € 1.000 € | 15.03. - 22.03.2025 800 € 1.000 € |
| 22.03. - 29.03.2025 800 € 1.000 € | 29.03. - 05.04.2025 800 € 1.000 € | 05.04. - 12.04.2025 800 € 1.000 € | 12.04. - 19.04.2025 800 € 1.000 € |
| 19.04. - 26.04.2025 Not available | 26.04. - 03.05.2025 1.152 € 1.440 € | 03.05. - 10.05.2025 1.600 € 2.000 € | 10.05. - 17.05.2025 1.600 € 2.000 € |
| 17.05. - 24.05.2025 2.432 € 3.040 € | 24.05. - 31.05.2025 2.432 € 3.040 € | 31.05. - 07.06.2025 2.432 € 3.040 € | 07.06. - 14.06.2025 2.432 € 3.040 € |
| 14.06. - 21.06.2025 2.656 € 3.320 € | 21.06. - 28.06.2025 2.656 € 3.320 € | 28.06. - 05.07.2025 2.656 € 3.320 € | |

PRICE AND AVAILABILITY

Sun Odyssey 380 4 Elli (2023)



| | | | |
|--|--|--|--|
| 05.07. - 12.07.2025 3.040 € 3.800 € | 12.07. - 19.07.2025 Not available | 19.07. - 26.07.2025 Not available | 26.07. - 02.08.2025 Not available |
| 02.08. - 09.08.2025 Not available | 09.08. - 16.08.2025 Not available | 16.08. - 23.08.2025 Not available | 23.08. - 30.08.2025 3.192 € 3.990 € |
| 30.08. - 06.09.2025 3.192 € 3.990 € | 06.09. - 13.09.2025 3.192 € 3.990 € | 13.09. - 20.09.2025 3.008 € 3.760 € | 20.09. - 27.09.2025 3.008 € 3.760 € |
| 27.09. - 04.10.2025 2.688 € 3.360 € | 04.10. - 11.10.2025 2.688 € 3.360 € | 11.10. - 18.10.2025 2.400 € 3.000 € | 18.10. - 25.10.2025 2.368 € 2.960 € |
| 25.10. - 01.11.2025 1.728 € 2.160 € | 01.11. - 08.11.2025 1.728 € 2.160 € | 08.11. - 15.11.2025 1.280 € 1.600 € | 15.11. - 22.11.2025 1.280 € 1.600 € |
| 22.11. - 29.11.2025 1.280 € 1.600 € | 30.11. - 31.12.2025 Not available | | |