

## **BALI 4.2 OW**

*Elifcim (2022)*



---

**Silver Sail Ltd • Kralja Zvonimira 14 • 21000 Split • Croatia**

Phone: +385 99 2608 224

E-mail: [info@silversail.hr](mailto:info@silversail.hr)

Web: [www.silversail.hr](http://www.silversail.hr)

---

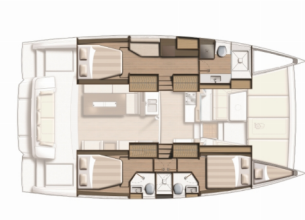

<b>Yacht Base</b>	Göcek, Turkey
<b>Yacht ID</b>	6109
<b>Yacht Brands</b>	Catana
<b>Yacht Name</b>	Elifcim
<b>Production Year</b>	2022
<b>Length</b>	42 Ft
<b>Cabins</b>	3 + 1
<b>Berths</b>	6 + 2 + 1
<b>Persons</b>	7
<b>WC/Shower</b>	3 + 1

**ADDITIONAL:** Flag

**COMFORT:** Blankets, Cockpit cushions, Pillows, Sun mattresses

**DECK:** Anchor with chain, Bilge pump - Mechanic, Bimini top, Black ball, Boat hook, Bosun's chair (Safe seat)(boatswain's chair), Canister for water, Cockpit light, Cockpit table, Cockpit/stern, outside shower, Davit, Deck brush, Dinghy (byboat) pump, Electric anchor windlass, Fenders, Flybridge, Fuel funnel, Gangway, Grill/Barbecue/Plancha, Impeller, V-belt, oilfilter, Jerry cans for diesel, Jerry cans for fuel, Mooring ropes , Plastic bucket, Repair box for dinghy, Round/globular fender, Spare anchor (Reserve, Auxiliary anchor), Sponge, Spring line, Swimming ladder, Water hose, Winch handles

**ENTERTAINMENT:** Mask and snorkel, Outdoor speakers

**GALLEY:** Dishwashing liquid, Gas bottles, Gas cookers, Hot water, Kitchen utensils (Galley equipment, cutlery), Microwave, Oven, Pressurized water system, Refrigerator, Sink

**INTERIOR:** Barometer, Clock, Convertible table in salon, Electric fans in cabins, Electric toilet

**NAVIGATION:** Autopilot, Binoculars, Compass, GPS chart plotter - cockpit, Hand bearing compass, Log, Nautical charts, Navigation (Nautical) charts and nautical guide , Navigation set, Radar reflector, Wind instrument/Anemometer, Windex

**SAFETY:** Black Water Tank, Distress signals, Emergency tiller, Fire blanket, Fire extinguisher , First aid kit , Fog horn, Life belts (Safety harness), Life buoy + Flashing light, Life jacket (children), Life jackets, Liferaft , Oars (Paddles), Repair kit, Search light, Set of tools , Sos Dan Buoy, Spare parts, Torch, VHF radio , Wire (shroud) cutter

**SAILS:** Electric main sail winch

**YACHT ELECTRICS:** Air Conditioning, Battery charger , Bilge pump - Electric, Generator, Inverter, Plug 220V, 12 V, Service batteries, Solar panels, Start battery, Watermaker - desalinator

## PRICE AND AVAILABILITY

Bali 4.2 OW Elifcim (2022)



---

<b>02.11. - 09.11.2024</b> 5.588 € <del>7.450 €</del>	<b>09.11. - 16.11.2024</b> 4.050 € <del>5.400 €</del>	<b>16.11. - 23.11.2024</b> 4.050 € <del>5.400 €</del>	<b>23.11. - 30.11.2024</b> 4.050 € <del>5.400 €</del>
<b>30.11. - 07.12.2024</b> 4.050 € <del>5.400 €</del>	<b>07.12. - 14.12.2024</b> 4.050 € <del>5.400 €</del>	<b>14.12. - 21.12.2024</b> 4.050 € <del>5.400 €</del>	<b>21.12. - 28.12.2024</b> 4.050 € <del>5.400 €</del>