

# LEOPARD 45

Dou Reve V (2022)



Silver Sail Ltd • Kralja Zvonimira 14 • 21000 Split • Croatia

Phone: +385 99 2608 224

E-mail: info@silversail.hr

Web: www.silversail.hr

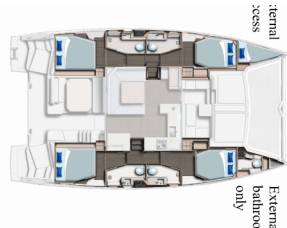

<b>Yacht Base</b>	Cannigione, Italy
<b>Yacht ID</b>	12395
<b>Yacht Brands</b>	Leopard
<b>Yacht Name</b>	Dou Reve V
<b>Production Year</b>	2022
<b>Length</b>	45 Ft
<b>Cabins</b>	4 + 1
<b>Berths</b>	8 + 2 + 1
<b>WC/Shower</b>	4 + 1

**COMFORT:** Pillows

**DECK:** Anchor with chain, Bilge pump - Mechanic, Bimini top, Boat hook, Bosun's chair (Safe seat)(boatswain's chair), Deck brush, Electric anchor windlass, Fenders, Flybridge, Fuel funnel, Gangway, Mooring ropes , Outboard engine, Plastic bucket, Spare anchor (Reserve, Auxiliary anchor), Swimming ladder, Tender, Water hose, Winch handles

**ENTERTAINMENT:** CD player, Fins, Outdoor speakers

**GALLEY:** Coffee machine, Gas bottles, Hot water, Kitchen utensils (Galley equipment, cutlery), Oven, Refrigerator, Stove

**INTERIOR:** Barometer, Clock, Water Purifier

**NAVIGATION:** Autopilot, Binoculars, Echosounder/Depthsounder, GPS chart plotter, Hand bearing compass, Log, Nautical charts, Pilot book, Radar reflector, Wind instrument/Anemometer

**SAFETY:** Buoyant smoke signal, Distress flare box, Emergency tiller, Fire extinguisher , First aid kit , Fog horn, Horseshoe lifebuoy, Life belts (Safety harness), Life jackets, Liferaft , Repair kit, Torch, VHF radio

**SAILS:** Electric winch

**YACHT ELECTRICS:** Air Conditioning, Bilge pump - Electric, Generator, Inverter, Solar panels, Watermaker - desalinator

## PRICE AND AVAILABILITY

Leopard 45 Dou Reve V (2022)



<b>02.11. - 09.11.2024</b> 5.670 € 6.300 €	<b>09.11. - 16.11.2024</b> 5.670 € 6.300 €	<b>16.11. - 23.11.2024</b> 5.670 € 6.300 €	<b>23.11. - 30.11.2024</b> 5.670 € 6.300 €
<b>30.11. - 07.12.2024</b> 5.670 € 6.300 €	<b>07.12. - 14.12.2024</b> 5.670 € 6.300 €	<b>14.12. - 21.12.2024</b> 5.670 € 6.300 €	<b>21.12. - 28.12.2024</b> 5.670 € 6.300 €
<b>04.01. - 11.01.2025</b> 4.680 € 5.200 €	<b>11.01. - 18.01.2025</b> 4.680 € 5.200 €	<b>18.01. - 25.01.2025</b> 4.680 € 5.200 €	<b>25.01. - 01.02.2025</b> 4.680 € 5.200 €
<b>01.02. - 08.02.2025</b> 4.680 € 5.200 €	<b>08.02. - 15.02.2025</b> 4.680 € 5.200 €	<b>15.02. - 22.02.2025</b> 4.680 € 5.200 €	<b>22.02. - 01.03.2025</b> 4.680 € 5.200 €
<b>01.03. - 08.03.2025</b> 4.680 € 5.200 €	<b>08.03. - 15.03.2025</b> 4.680 € 5.200 €	<b>15.03. - 22.03.2025</b> 4.680 € 5.200 €	<b>22.03. - 29.03.2025</b> 4.680 € 5.200 €
<b>29.03. - 05.04.2025</b> 4.680 € 5.200 €	<b>05.04. - 12.04.2025</b> 7.290 € 8.100 €	<b>12.04. - 19.04.2025</b> 7.290 € 8.100 €	<b>19.04. - 26.04.2025</b> 7.290 € 8.100 €
<b>26.04. - 03.05.2025</b> 7.290 € 8.100 €	<b>03.05. - 10.05.2025</b> 7.290 € 8.100 €	<b>10.05. - 17.05.2025</b> 7.290 € 8.100 €	<b>17.05. - 24.05.2025</b> Not available
<b>24.05. - 31.05.2025</b> 7.650 € 8.500 €	<b>31.05. - 07.06.2025</b> Not available	<b>07.06. - 14.06.2025</b> Not available	<b>14.06. - 21.06.2025</b> Not available
<b>21.06. - 28.06.2025</b> Not available	<b>28.06. - 05.07.2025</b> Not available		

## PRICE AND AVAILABILITY

Leopard 45 Dou Reve V (2022)



<b>05.07. - 12.07.2025</b> 9.405 € <del>10.450 €</del>	<b>12.07. - 19.07.2025</b> Not available	<b>19.07. - 26.07.2025</b> Not available	<b>26.07. - 02.08.2025</b> 10.170 € <del>11.300 €</del>
<b>02.08. - 09.08.2025</b> 10.170 € <del>11.300 €</del>	<b>09.08. - 16.08.2025</b> 10.800 € <del>12.000 €</del>	<b>16.08. - 23.08.2025</b> Not available	<b>23.08. - 30.08.2025</b> 10.530 € <del>11.700 €</del>
<b>30.08. - 06.09.2025</b> 10.530 € <del>11.700 €</del>	<b>06.09. - 13.09.2025</b> Not available	<b>13.09. - 20.09.2025</b> 10.080 € <del>11.200 €</del>	<b>20.09. - 27.09.2025</b> Not available
<b>27.09. - 04.10.2025</b> 6.930 € <del>7.700 €</del>	<b>04.10. - 11.10.2025</b> 6.930 € <del>7.700 €</del>	<b>11.10. - 18.10.2025</b> 6.930 € <del>7.700 €</del>	<b>18.10. - 25.10.2025</b> 4.680 € <del>5.200 €</del>
<b>25.10. - 01.11.2025</b> 4.680 € <del>5.200 €</del>	<b>01.11. - 08.11.2025</b> 4.680 € <del>5.200 €</del>	<b>08.11. - 15.11.2025</b> 4.680 € <del>5.200 €</del>	<b>15.11. - 22.11.2025</b> 4.680 € <del>5.200 €</del>
<b>22.11. - 29.11.2025</b> 4.680 € <del>5.200 €</del>	<b>29.11. - 06.12.2025</b> 4.680 € <del>5.200 €</del>	<b>06.12. - 13.12.2025</b> 4.680 € <del>5.200 €</del>	<b>13.12. - 20.12.2025</b> 4.680 € <del>5.200 €</del>
<b>20.12. - 27.12.2025</b> 4.680 € <del>5.200 €</del>			