

# FONTAINE PAJOT TANNA 47

*Positive Energy (2023)*



---

**Silver Sail Ltd • Kralja Zvonimira 14 • 21000 Split • Croatia**

Phone: +385 99 2608 224

E-mail: [info@silversail.hr](mailto:info@silversail.hr)

Web: [www.silversail.hr](http://www.silversail.hr)

---

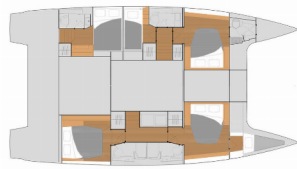

<b>Yacht Base</b>	Seychelles, Eden Island Marina, Seychelles
<b>Yacht ID</b>	11789
<b>Yacht Brands</b>	Fountaine Pajot
<b>Yacht Name</b>	Positive Energy
<b>Production Year</b>	2023
<b>Length</b>	46 Ft
<b>Cabins</b>	5 + 1
<b>Berths</b>	10 + 1
<b>Persons</b>	11
<b>WC/Shower</b>	4 + 1

**COMFORT:** Blankets, Cockpit cushions, Deck cushions, Outside cushions, Pillows

**DECK:** Anchor with chain, Bilge pump - Mechanic, Bimini top, Boat hook, Bosun's chair (Safe seat)(boatswain's chair), Cockpit table, Cockpit/stern, outside shower, Deck brush, Deck lights, Dinghy with outboard engine, Electric anchor windlass, Fenders, Gangway, Jerry cans for fuel, Mooring Cleats, Mooring ropes , Round/globular fender, Spare anchor (Reserve, Auxiliary anchor), Sponge, Spring cleats, Swimming ladder, Teak cockpit, Water hose, Winch handles

**ENTERTAINMENT:** Fins, Mask and snorkel, Radio CD mp3 player + USB, Wi-Fi Internet

**GALLEY:** Freezer, Gas bottles, Gas cookers, Kitchen towel, Kitchen utensils (Galley equipment, cutlery), Oven, Refrigerator, Water pump

**INTERIOR:** Clothes hangers, Curtains, Electric fans in cabins, LED interior lights, Toilet brush

**NAVIGATION:** Autopilot, Compass, GPS chart plotter, Nautical charts, Navigation set, Radar reflector, Tridata, Windex

**SAFETY:** Black Water Tank, Distress flare box, Emergency tiller, Fire extinguisher , First aid kit , Flashlight, Fog horn, Horseshoe lifebuoy, Life belts (Safety harness), Life jacket (children), Life jackets, Liferaft , Rescue sling (Life sling), Set of tools , Signal flags, Spare parts, Torch, VHF radio , Wire (shroud) cutter

**SAILS:** Electric genoa winch, Electric main sail winch, Electric winch, Lazy bag, Lazy jacks, Winch

**YACHT ELECTRICS:** 110V socket, Air Conditioning, Bilge pump - Electric, DSC station, Generator, Inverter, Service batteries, Shore power cable, Start battery, USB sockets, Water heater, Watermaker - desalinator, WC pump

## PRICE AND AVAILABILITY

Fountaine Pajot Tanna 47 Positive Energy (2023)



<b>02.11. - 09.11.2024</b> Not available	<b>09.11. - 16.11.2024</b> Not available	<b>16.11. - 23.11.2024</b> Not available	<b>23.11. - 30.11.2024</b> Not available
<b>30.11. - 14.12.2024</b> Not available	<b>14.12. - 21.12.2024</b> 6.717 € <del>8.956 €</del>	<b>27.12. - 01.01.2025</b> Not available	<b>04.01. - 11.01.2025</b> Not available
<b>11.01. - 18.01.2025</b> 8.865 € <del>9.850 €</del>	<b>18.01. - 25.01.2025</b> 8.865 € <del>9.850 €</del>	<b>25.01. - 01.02.2025</b> 8.865 € <del>9.850 €</del>	<b>01.02. - 08.02.2025</b> 10.548 € <del>11.720 €</del>
<b>08.02. - 15.02.2025</b> 13.068 € <del>14.520 €</del>	<b>17.02. - 24.02.2025</b> Not available	<b>03.03. - 12.03.2025</b> Not available	<b>15.03. - 29.03.2025</b> Not available
<b>29.03. - 05.04.2025</b> 12.690 € <del>14.100 €</del>	<b>05.04. - 12.04.2025</b> Not available	<b>12.04. - 19.04.2025</b> 12.690 € <del>14.100 €</del>	<b>19.04. - 03.05.2025</b> Not available
<b>03.05. - 10.05.2025</b> 8.604 € <del>9.560 €</del>	<b>10.05. - 17.05.2025</b> 7.740 € <del>8.600 €</del>	<b>17.05. - 24.05.2025</b> 7.902 € <del>8.780 €</del>	<b>24.05. - 31.05.2025</b> 7.902 € <del>8.780 €</del>
<b>31.05. - 07.06.2025</b> 7.110 € <del>7.900 €</del>	<b>07.06. - 14.06.2025</b> 7.110 € <del>7.900 €</del>	<b>14.06. - 21.06.2025</b> 7.110 € <del>7.900 €</del>	<b>21.06. - 28.06.2025</b> 7.110 € <del>7.900 €</del>
<b>28.06. - 05.07.2025</b> 7.317 € <del>8.130 €</del>			

## PRICE AND AVAILABILITY

Fountaine Pajot Tanna 47 Positive Energy (2023)



<b>05.07. - 12.07.2025</b> 7.740 € 8.600€	<b>12.07. - 19.07.2025</b> 7.740 € 8.600€	<b>19.07. - 26.07.2025</b> 10.008 € 11.120€	<b>26.07. - 02.08.2025</b> 10.008 € 11.120€
<b>02.08. - 09.08.2025</b> 10.008 € 11.120€	<b>09.08. - 16.08.2025</b> 10.008 € 11.120€	<b>16.08. - 23.08.2025</b> 5.922 € 6.580€	<b>23.08. - 30.08.2025</b> 6.219 € 6.910€
<b>30.08. - 06.09.2025</b> 6.219 € 6.910€	<b>06.09. - 13.09.2025</b> 6.219 € 6.910€	<b>13.09. - 20.09.2025</b> 6.219 € 6.910€	<b>20.09. - 27.09.2025</b> Not available
<b>27.09. - 04.10.2025</b> 9.594 € 10.660€	<b>04.10. - 11.10.2025</b> 11.286 € 12.540€	<b>11.10. - 18.10.2025</b> 11.286 € 12.540€	<b>18.10. - 25.10.2025</b> 11.286 € 12.540€
<b>25.10. - 01.11.2025</b> 11.286 € 12.540€	<b>01.11. - 08.11.2025</b> 11.286 € 12.540€	<b>08.11. - 15.11.2025</b> 11.286 € 12.540€	<b>15.11. - 22.11.2025</b> 11.286 € 12.540€
<b>22.11. - 29.11.2025</b> 8.604 € 9.560€	<b>29.11. - 06.12.2025</b> 5.922 € 6.580€	<b>06.12. - 13.12.2025</b> 5.922 € 6.580€	<b>13.12. - 20.12.2025</b> 5.922 € 6.580€
<b>20.12. - 27.12.2025</b> 14.100 €			